

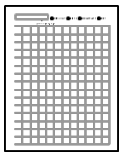

How to measure for kitchen cabinets.

Example Drawing

Tools Needed



Graph Paper



Pencil



Tape Measure

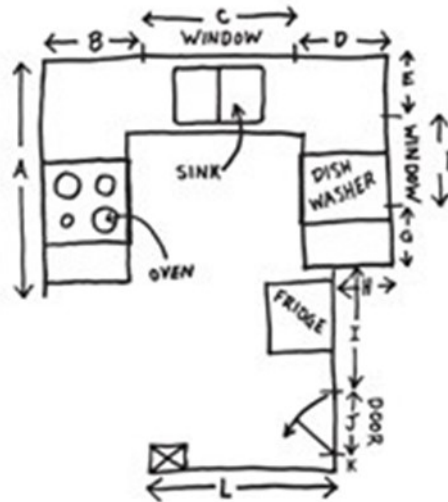

KEY	
A	= 100"
B	= 36"
C	= 72"
D	= 36"
E	= 18"
F	= 48"
G	= 18"
H	= 12"
I	= 60"
J	= 32"
K	= 4"
L	= 48"

Our Measure Guide is easy to use (yes, it really is easy) and helps collect the basic information to help you and your designer start your design. This does not have to be a work of art but just a clear and accurate drawing of your space. If you want to use the attached graph paper, that's great. If not, then all we need is your drawing. Please Call 315-433-1038

Step 1: Your Kitchen Shape Draw your kitchen as a box showing all the walls that you think will have cabinets. Be sure to include any major structural features or obstacles.

Step 2: Draw It Out Mark any openings such as windows and doorways. Be sure to include radiators or other obstacles that affect where cabinets can be installed. Now, label all the openings in your kitchen. In this sketch we'll use areas A thru I. Record these letters as a key on your sketch.

Step 3: Measure Now it's time to get out the tape measure. Measure all the openings, from outside edge to outside edge, and fill in the key. If you're uncomfortable with precise measurements feel free to round to the nearest inch. Remember this is just to get started, your designer will confirm details later.

Step 4: Your Layout Most people already have a good idea of where the major items will go in their kitchen. Feel free to draw your ideas of what you would like and include the placement of your sink and appliances.

Pictures of Your Kitchen What can really help your designer is to take 'before' pictures of your kitchen and send them along with your measurements. That's it! You're done! It is that easy to measure your kitchen.

